

PGSEAR-16 HARDWARE KIT

QTY 6 M6X20

QTY 2 M6X15

QTY 8 M6 FLAT WASHER

QTY 8 M6 LOCK WASHER

QTY 1 2MM ALLEN WRENCH

PGSEAR PARTS LIST

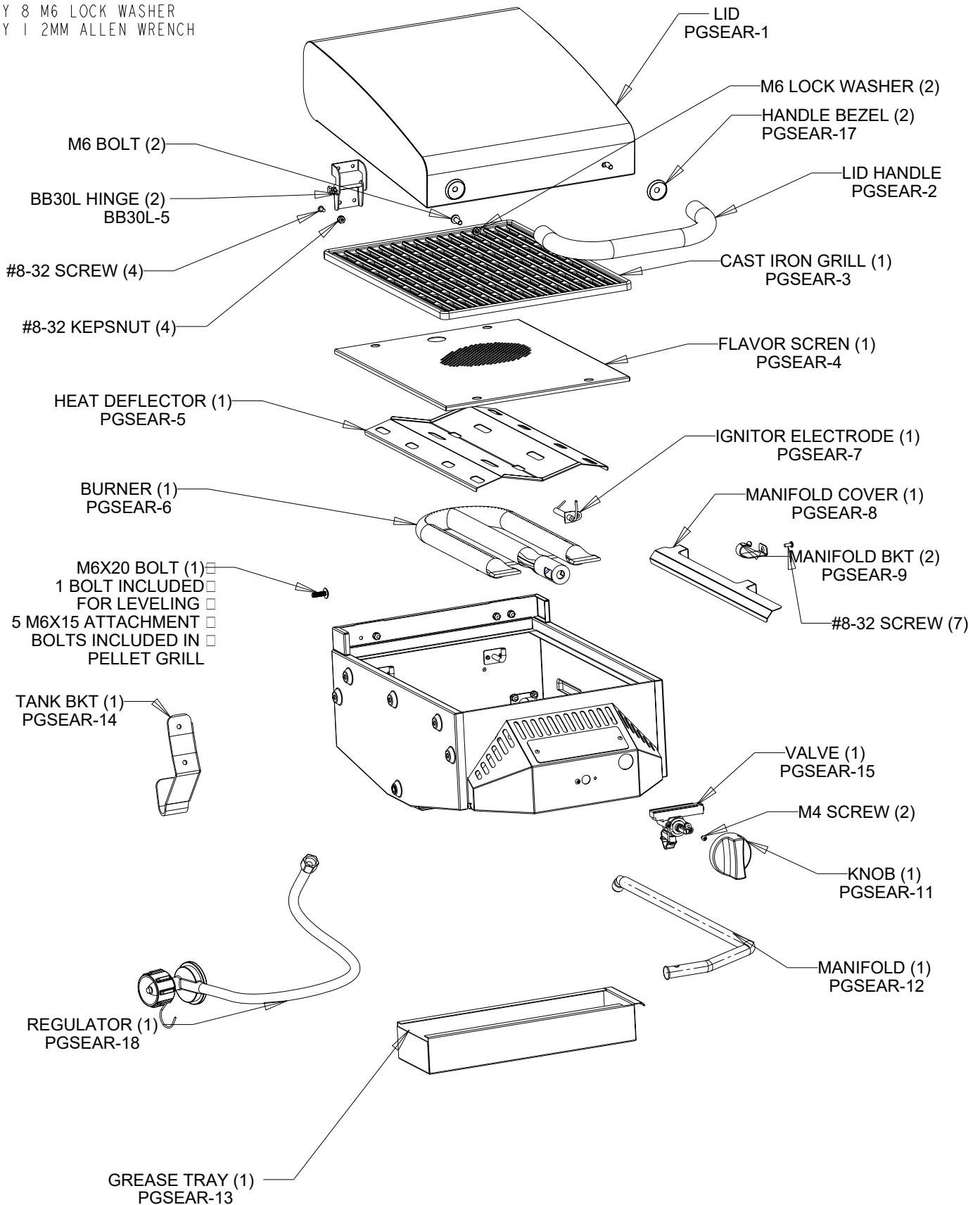

1. Remove Qty (2) bolts from rear right leg. ☐
- ☐
2. Install the propane tank bracket as shown using existing hardware from pellet grill. ☐
- ☐
3. Remove cast iron grate, flavor screen, and heat deflector from the sear and set aside ☐
- ☐
4. Remove side shelf from grill. ☐
- ☐
5. Install sear as shown using the existing shelf hardware from grill. ☐
- ☐
6. Level the sear using the leveling screw. (Note: Make sure the lid does not interfere with the rivets on the side of the grill.) ☐
- ☐
7. Install heat deflector as shown. ☐
- ☐
8. Install flavor screen as shown with finger hole at the back. ☐
- ☐
9. Install cast iron grate as shown. ☐
- ☐
10. Install handle as shown using the supplied hardware. ☐
- ☐
11. Install knob and tighten the set screw in the bottom with the allen wrench that is included. ☐
- ☐
12. Install grease tray. ☐
- ☐
- ☐

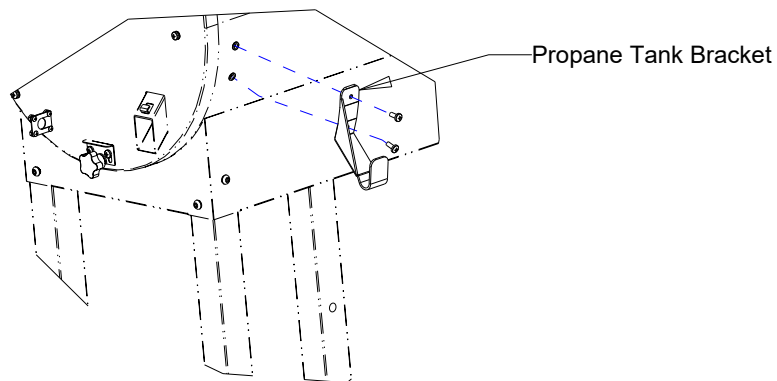

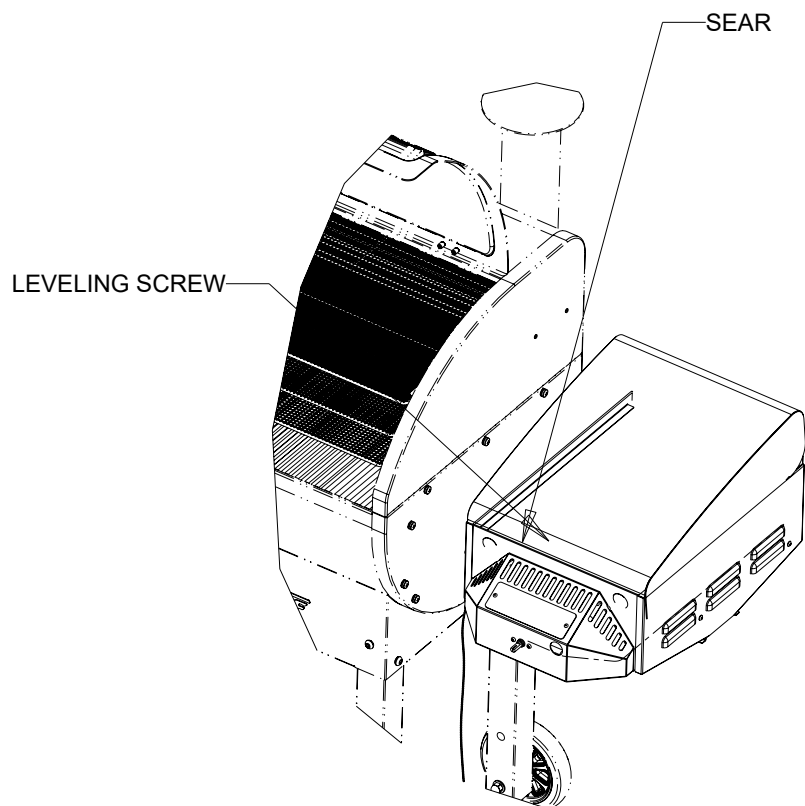

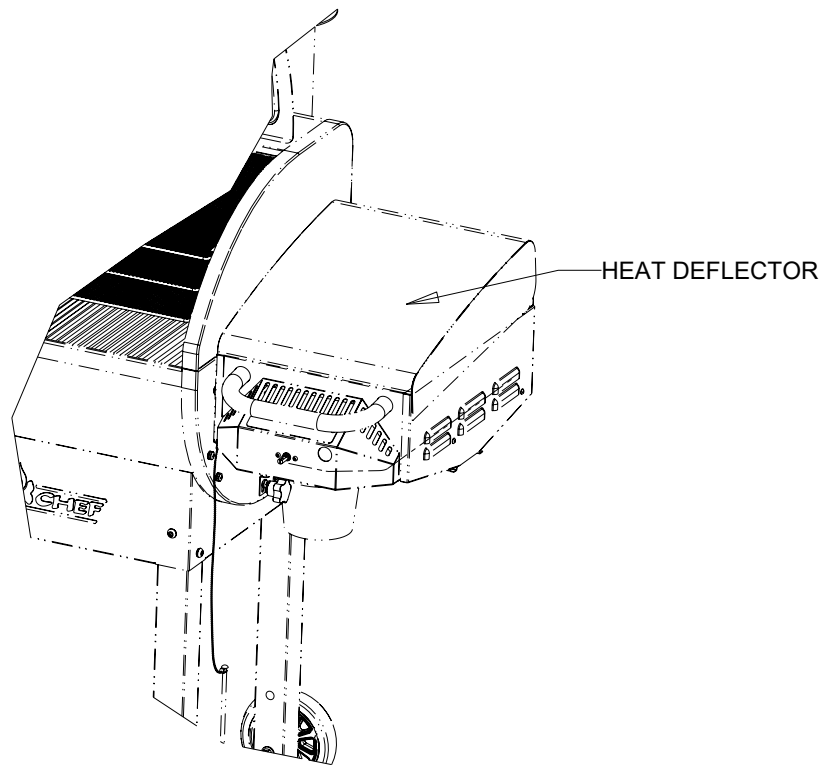

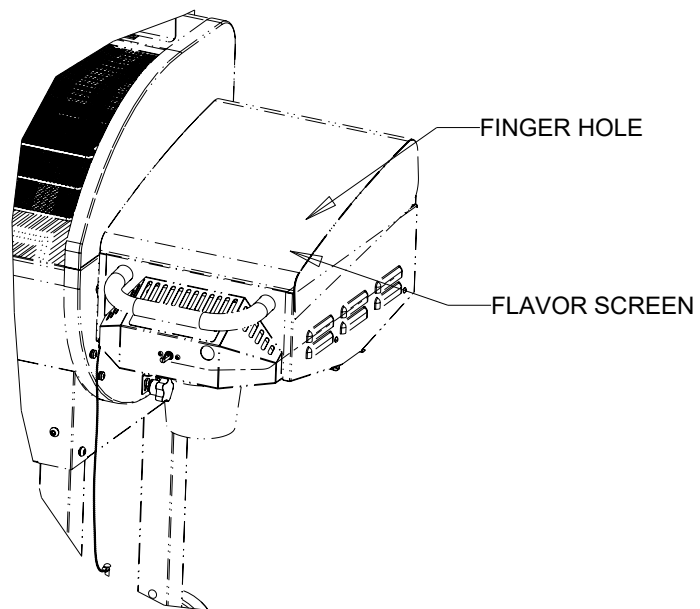

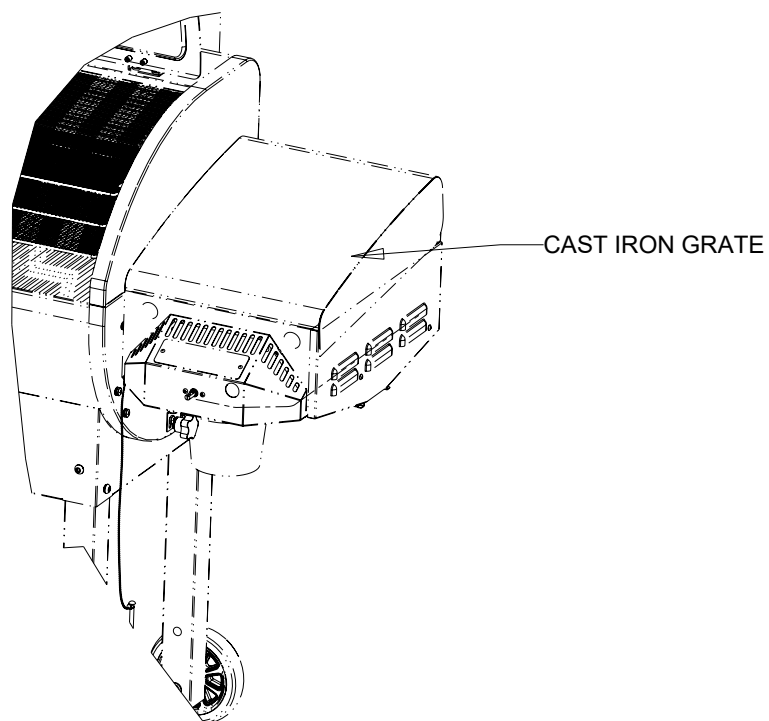

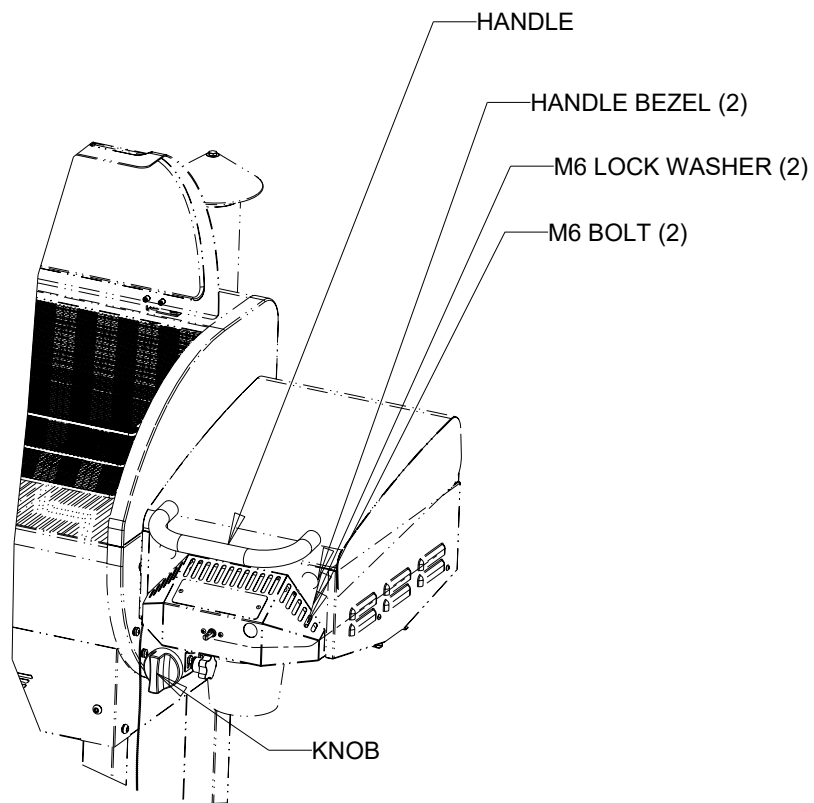

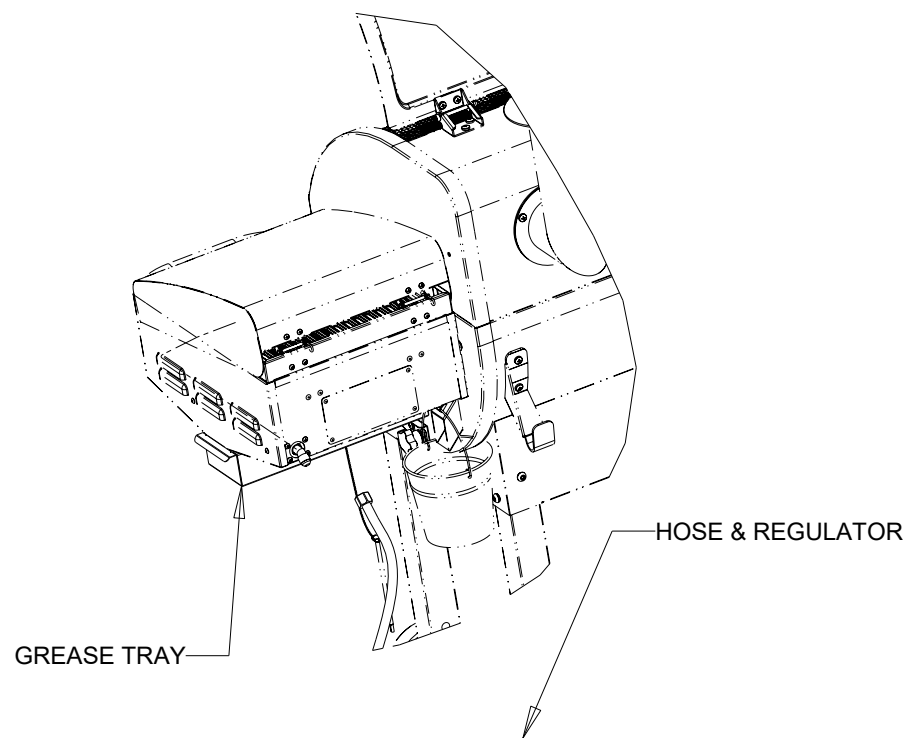

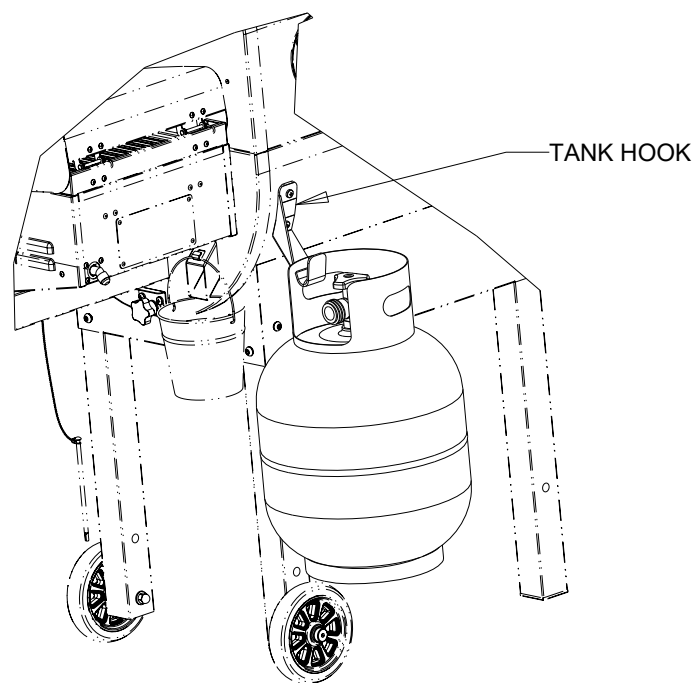

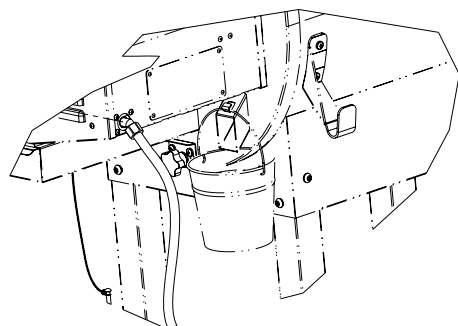

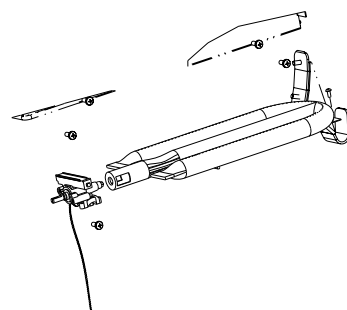

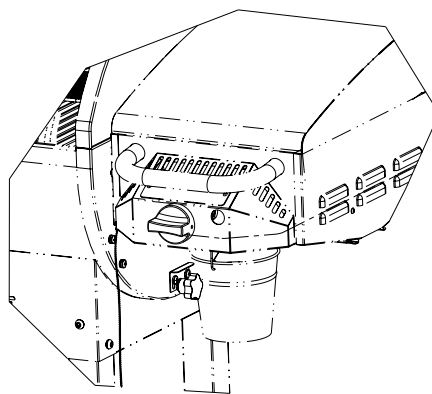

SCALE 0.100

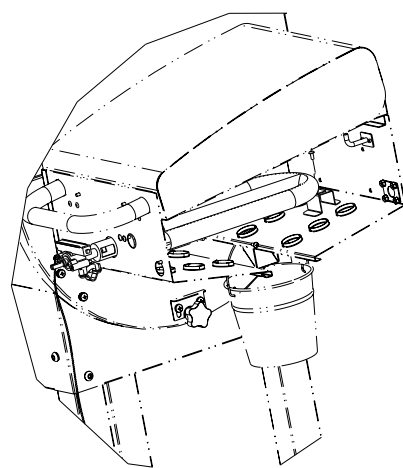

SCALE 0.100

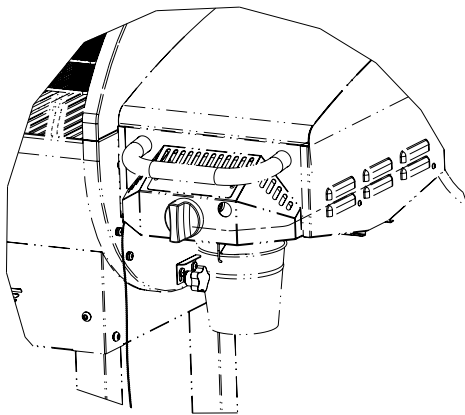

SCALE 0.100