

How to Change a Smoke Vault Valve



Warning: Before you begin make sure the item is removed from the propane tank.

Make sure everything is turned off and disconnect the hose from your smoker. Then lay the smoker on it's back and This will give you access to the valve. Follow the next steps.



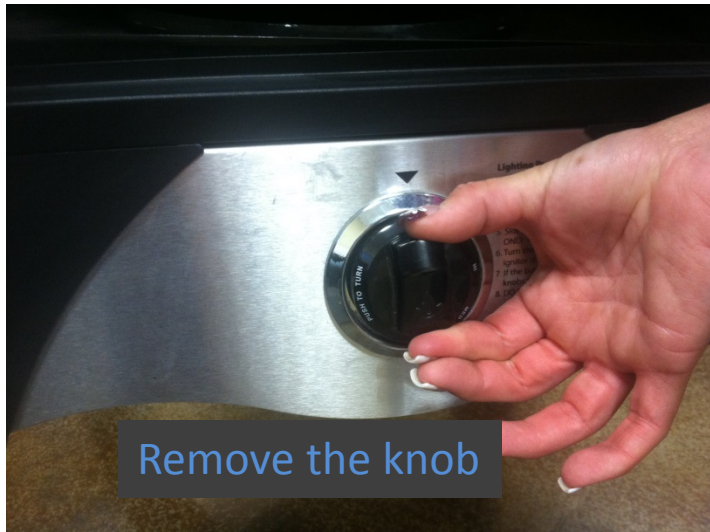

Remove the knob



Take the two screws out of the knob bezel



Take the bezel off



Remove the four screws from the burner drum.

Remove the
burner Drum



Remove the
two screws on
the valve
bracket.



Remove the valve from
the burner and replace
with the new valve.



If after troubleshooting with this manual, if you are still experiencing problems, please contact our customer service department. Our agents will be happy to help. You can contact them at
1-800-650-2433

Note: The Manufacturer is not liable for any replacement parts, equipment, and/or injury due to improper installation or modification.